



SMA Male Connector Field Replaceable Attachment
4 Hole Flange 0.036 inch Pin, .375 inch Flange Size

TECHNICAL DATA SHEET

PE44009

SMA Male Connector Field Replaceable Attachment 4 Hole Flange 0.036 inch Pin, .375 inch Flange Size

Configuration

Connector	SMA Male
Connector Interface Type	0.036 inch Pin
Cable Attachment Method (Shield/Contact)	Field Replaceable
Body Style	Straight
Mount Method	4 Hole Flange

Electrical Specifications

Impedance, Ohms	50
-----------------	----

Mechanical Specifications

Size

Length, in [mm]	0.5 [12.7]
Width/Dia., in [mm]	0.375 [9.53]
Height, in [mm]	0.375 [9.53]
Weight, lbs [g]	0.013 [5.9]

Connector

Type	SMA Male
Contact Material and Plating	Gold
Coupling Nut Material and Plating	Brass, Nickel
Hex Size, in.	5/16
Torque, in-lbs [Nm]	5 [0.57]
Body Material and Plating	Passivated Stainless Steel
Dielectric Type	PTFE

Compliance Certifications (visit www.Pasternack.com for current document)

RoHS Compliant	Yes
----------------	-----

Click the following link (or enter part number in "SEARCH" on website) to obtain additional part information including price, inventory and certifications: [SMA Male Connector Field Replaceable Attachment 4 Hole Flange 0.036 inch Pin, .375 inch Flange Size PE44009](#)

The information contained in this document is accurate to the best of our knowledge and representative of the part described herein. It may be necessary to make modifications to the part and/or the documentation of the part, in order to implement improvements. Pasternack reserves the right to make such changes as required. Unless otherwise stated, all specifications are nominal.



SMA Male Connector Field Replaceable Attachment
4 Hole Flange 0.036 inch Pin, .375 inch Flange Size

TECHNICAL DATA SHEET

PE44009

Plotted and Other Data

Notes:

Values at 25 °C, sea level

SMA Male Connector Field Replaceable Attachment 4 Hole Flange 0.036 inch Pin, .375 inch Flange Size from Pasternack Enterprises has same day shipment for domestic and International orders. Our RF, microwave and fiber optic products maintain a 99% availability and are part of the broadest selection in the industry.

Click the following link (or enter part number in "SEARCH" on website) to obtain additional part information including price, inventory and certifications: [SMA Male Connector Field Replaceable Attachment 4 Hole Flange 0.036 inch Pin, .375 inch Flange Size PE44009](http://www.pasternack.com/sma-male-standard-0.036-pin-connector-pe44009-p.aspx)

URL: <http://www.pasternack.com/sma-male-standard-0.036-pin-connector-pe44009-p.aspx>

The information contained in this document is accurate to the best of our knowledge and representative of the part described herein. It may be necessary to make modifications to the part and/or the documentation of the part, in order to implement improvements. Pasternack reserves the right to make such changes as required. Unless otherwise stated, all specifications are nominal.

PE44009 CAD Drawing

SMA Male Connector Field Replaceable Attachment 4 Hole
Flange 0.036 inch Pin, .375 inch Flange Size

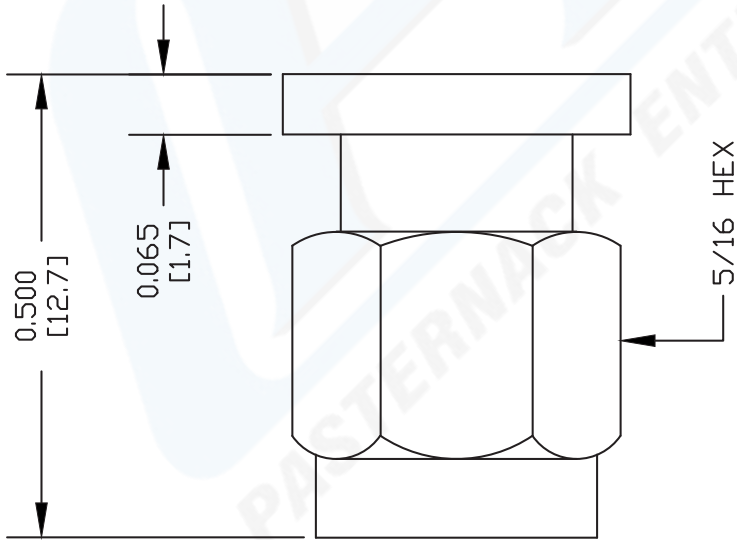
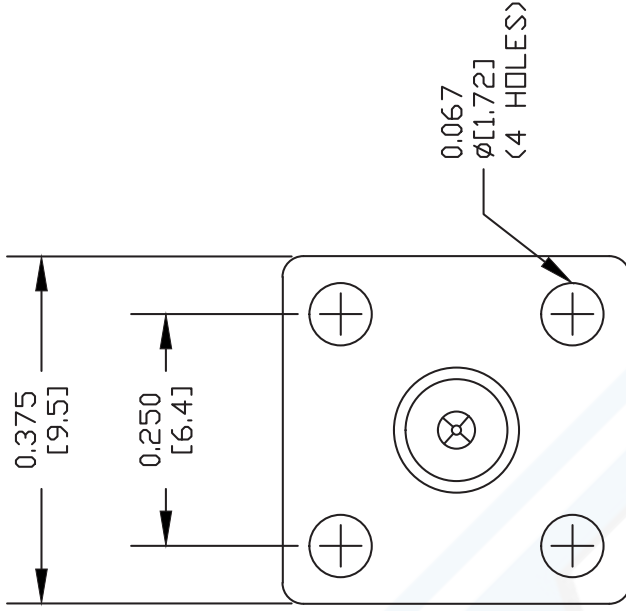

- NOTES:
1. UNLESS OTHERWISE SPECIFIED ALL DIMENSIONS ARE NOMINAL.
 2. ALL SPECIFICATIONS ARE SUBJECT TO CHANGE WITHOUT NOTICE AT ANY TIME.
 3. DIMENSIONS ARE IN INCHES [mm].
 4. FITS MIL-C-17 AND EQUIVALENT CABLES.

DWG TITLE
PE44009

FSCM NO. 53919

127

SIZE A

SCALE N/A

CAD FILE 061902

PE PASTERNAK®
Pasternack Enterprises, Inc.
P.O. Box 16759 | Irvine | CA | 92623
Phone: (949) 261-1920 | Fax: (949) 261-7451
Website: www.pasternack.com | E-Mail: sales@pasternack.com