



Push-On SMP Female to SMP Female Push-On Adapter .370 Special Length

RF Adapters Technical Data Sheet

PE91072

Configuration

- Push-On SMP Female Connector 1
- Push-On SMP Female Connector 2
- 50 Ohms
- Straight Body Geometry

Features

- Max VSWR of 1.15:1 up to 18 GHz
- Gold Plated Beryllium Copper Contact

Applications

- General Purpose Test

Description

Pasternack's PE91072 push-on SMP female to SMP female push-on adapter is part of our full line of RF components available for same-day shipping. Our SMP to SMP adapter has a female to female gender configuration. PE91072 SMP female to SMP female adapter is gold plated and operates to 18 GHz. The Pasternack RF adapter provides excellent VSWR of 1.15:1 maximum.

RF adapters are often used to enable connections between two connector types that would otherwise not mate. Certain adapter configurations can also be used to protect connectors on expensive equipment where the number of connect/disconnect cycles is high. An RF, microwave or millimeter wave adapter is connected to the equipment, and the commonly changed connection is made with the adapter which can be easily replaced when it wears out after high usage; such adapters are referred to as connector savers. Pasternack also offers bulkhead, panel mount, hermetically sealed, reverse polarity, and isolated ground adapter varieties to serve all of your RF, microwave and millimeter wave needs.

Electrical Specifications

Description	Minimum	Typical	Maximum	Units
Frequency Range	DC		18	GHz
VSWR			1.15:1	
Insertion Loss			0.42	dB
Operating Voltage (AC)			335	Vrms
Dielectric Withstanding Voltage (AC)			500	Vrms
Insulation Resistance	5,000			MOhms

Electrical Specification Notes:
 RF Leakage: -80dB to 3 GHz, -65dB to 12 GHz

Mechanical Specifications

Size	
Length	0.37 in [9.4 mm]
Width	0.13 in [3.3 mm]
Weight	0.01 lbs [4.54 g]

Click the following link (or enter part number in "SEARCH" on website) to obtain additional part information including price, inventory and certifications: [Push-On SMP Female to SMP Female Push-On Adapter .370 Special Length PE91072](#)



Push-On SMP Female to SMP Female Push-On Adapter .370 Special Length

RF Adapters Technical Data Sheet

PE91072

Description	Connector 1	Connector 2
Type	SMP Female	SMP Female
Polarity	Standard	Standard

Material Specifications

Description	Connector 1		Connector 2	
	Material	Plating	Material	Plating
Type	Push-On SMP Female		Push-On SMP Female	
Contact	Beryllium Copper	Gold	Beryllium Copper	Gold
Insulation	PTFE		PTFE	
Outer Conductor	Beryllium Copper	Gold	Beryllium Copper	Gold
Body	Beryllium Copper	Gold	Beryllium Copper	Gold

Environmental Specifications

Temperature

Operating Range -65 to +165 deg C

Compliance Certifications (see [product page](#) for current document)

Plotted and Other Data

Notes:

Click the following link (or enter part number in "SEARCH" on website) to obtain additional part information including price, inventory and certifications: [Push-On SMP Female to SMP Female Push-On Adapter .370 Special Length PE91072](#)



Push-On SMP Female to SMP Female Push-On Adapter .370 Special Length

RF Adapters Technical Data Sheet

PE91072

Typical Performance Data

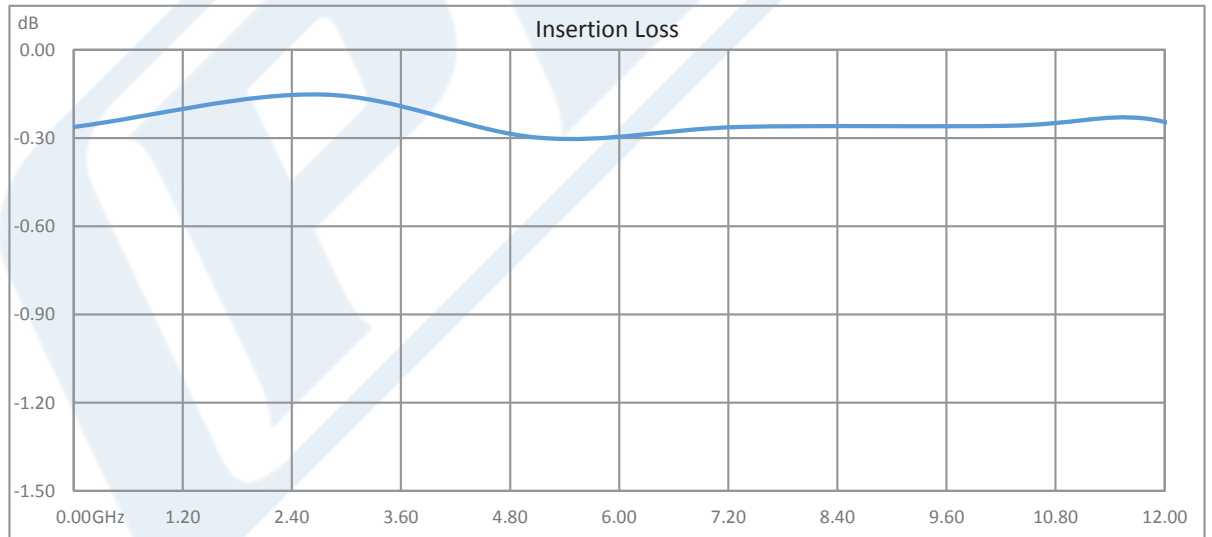
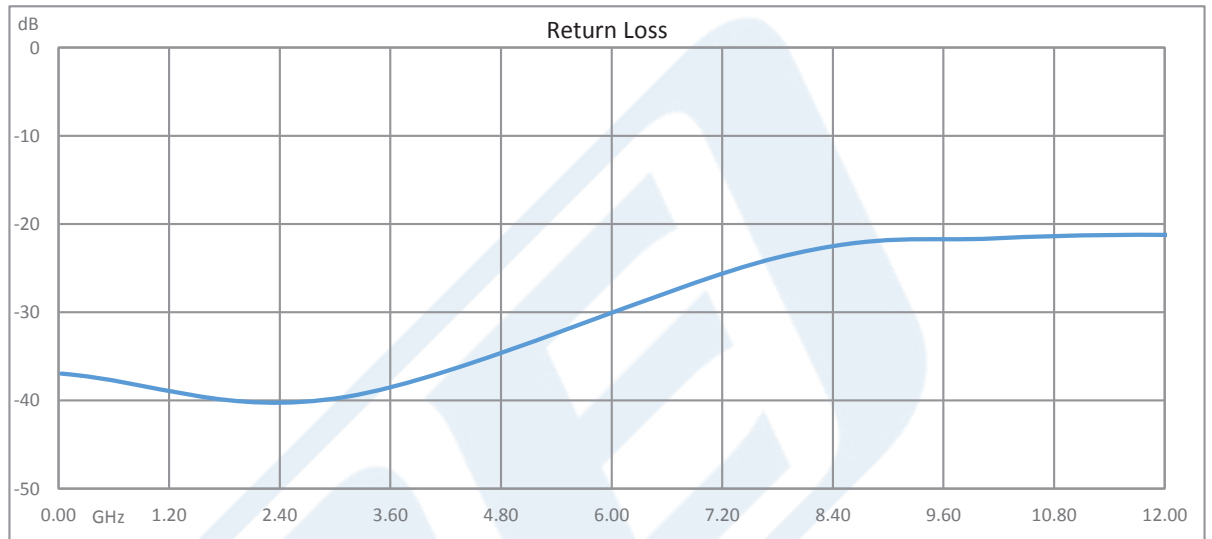

Click the following link (or enter part number in "SEARCH" on website) to obtain additional part information including price, inventory and certifications: [Push-On SMP Female to SMP Female Push-On Adapter .370 Special Length PE91072](#)



Push-On SMP Female to SMP Female Push-On Adapter .370 Special Length

RF Adapters Technical Data Sheet

PE91072

Push-On SMP Female to SMP Female Push-On Adapter .370 Special Length from Pasternack Enterprises has same day shipment for domestic and International orders. Our RF, microwave and millimeter wave products maintain a 99% availability and are part of the broadest selection in the industry.

Click the following link (or enter part number in "SEARCH" on website) to obtain additional part information including price, inventory and certifications: [Push-On SMP Female to SMP Female Push-On Adapter .370 Special Length PE91072](https://www.pasternack.com/smp-female-smp-female-straight-adapter-pe91072-p.aspx)

URL: <https://www.pasternack.com/smp-female-smp-female-straight-adapter-pe91072-p.aspx>

The information contained in this document is accurate to the best of our knowledge and representative of the part described herein. It may be necessary to make modifications to the part and/or the documentation of the part, in order to implement improvements. Pasternack reserves the right to make such changes as required. Unless otherwise stated, all specifications are nominal. Pasternack does not make any representation or warranty regarding the suitability of the part described herein for any particular purpose, and Pasternack does not assume any liability arising out of the use of any part or documentation.

PE91072 CAD Drawing

Push-On SMP Female to SMP Female Push-On Adapter .370 Special Length

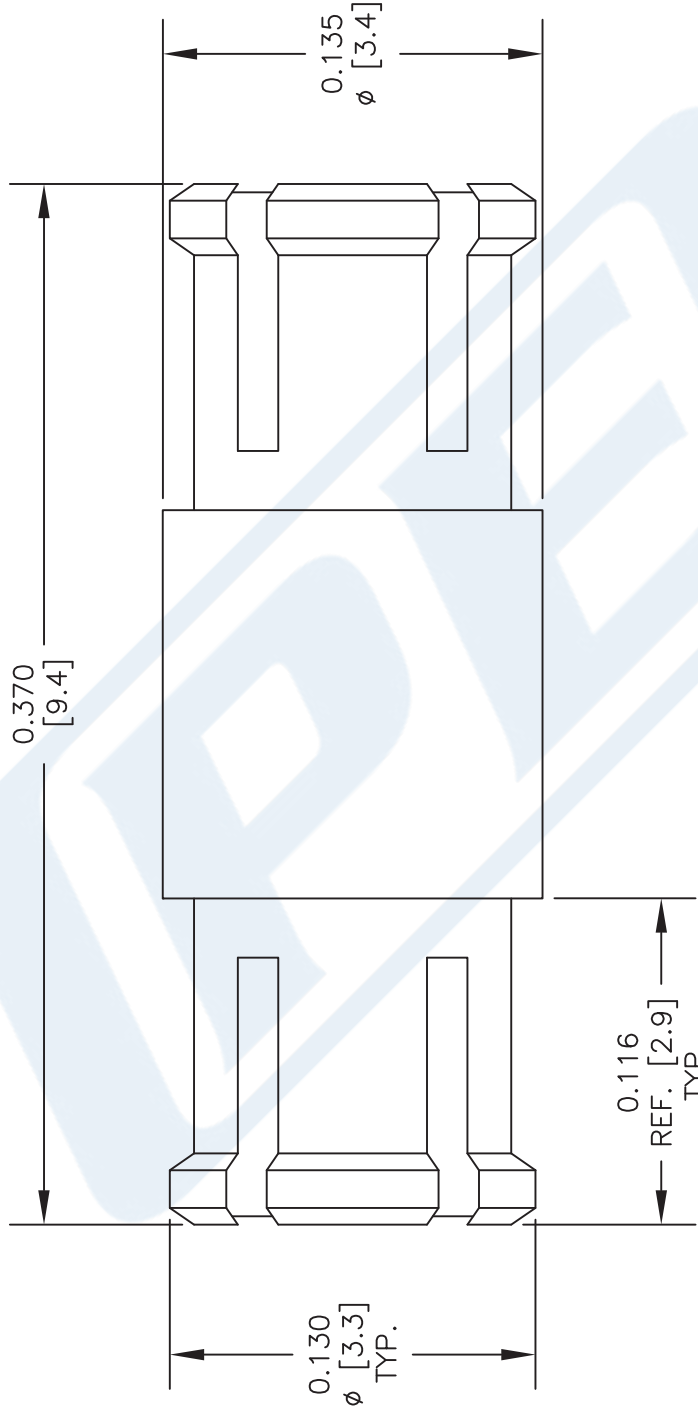

NOTES:
 1. UNLESS OTHERWISE SPECIFIED ALL DIMENSIONS ARE NOMINAL.
 2. ALL SPECIFICATIONS ARE SUBJECT TO CHANGE WITHOUT NOTICE AT ANY TIME.
 3. DIMENSIONS ARE IN INCHES [mm].

DWG TITLE
PE91072

FSCM NO. 53919

XXXX

SIZE A

SCALE N/A

XXXXXX

CAD FILE

PE PASTERNAK
 THE ENGINEER'S RF SOURCE
 Pasternack Enterprises, Inc.
 P.O. Box 16759 | Irvine | CA | 92623

Phone: (949) 261-1920 | Fax: (949) 261-7451

Website: www.pasternack.com | E-Mail: sales@pasternack.com