



WR-12 Waveguide Circulator, 64.5 GHz to 66.5 GHz,  
15 dB min Isolation, UG-387/U Cover Flange, Brass

## Waveguide Circulators Technical Data Sheet

**PE-W12CR001**

### Features

- WR-12 Waveguide Circulator
- E Band Frequency Range 64.5 to 66.5 GHz
- UG-387/U Flange Configuration
- Maximum VSWR 1.4:1
- Minimum 15 dB isolation
- Maximum Power 2 W (CW)

### Applications

- Radar Systems
- Military
- Wireless Radio Systems
- Telecom Infrastructure
- Communication Systems
- R&D Labs
- Microwave Radio Systems

### Description

The PE-W12CR001 is a Waveguide Circulator offering 15 dB minimum isolation over the E band frequency range of 64.5 to 66.5 GHz. The design achieves high isolation with wide band performance and the WR-12 waveguide uses UG-387/U compatible flanges on all ports and has a power rating of 2 watts (CW).

Pasternack offers a wide variety of circulators and waveguide circulators to fit your needs. These unique devices enable two signals to use one channel. The classic use of this three port device is for the line between an antenna and a transceiver, allowing the receive signal to come from the antenna (port 1) to the receiver (port 2) while the transmit signal goes from the transmitter (port 3) to the antenna (port 1). An isolator can be created by terminating one port into a matched load. These components can be used in antenna transmitting and receiving, radar, amplifier systems and anything that requires isolation from a signal reflection and the ability to send signals in opposite directions down a single channel. These circulators feature excellent insertion loss, high isolation and reliability.

### Electrical Specifications

Description	Minimum	Typical	Maximum	Units
Frequency Range	64.5		66.5	GHz
VSWR			1.4:1	
Insertion Loss			0.8	dB
Isolation	15			dB
Forward Power (CW)			2	Watts
Input Power (Peak)			20	Watts

Click the following link (or enter part number in "SEARCH" on website) to obtain additional part information including price, inventory and certifications: [WR-12 Waveguide Circulator, 64.5 GHz to 66.5 GHz, 15 dB min Isolation, UG-387/U Cover Flange, Brass PE-W12CR001](#)



WR-12 Waveguide Circulator, 64.5 GHz to 66.5 GHz,  
15 dB min Isolation, UG-387/U Cover Flange, Brass

## Waveguide Circulators Technical Data Sheet

**PE-W12CR001**

### Mechanical Specifications

#### Size

Length	1.15 in [29.21 mm]
Width	0.79 in [20.07 mm]
Height	1.1 in [27.94 mm]
Weight	0.15 lbs [68.04 g]

Waveguide Size	WR-12
Flange Designation	UG-387/U
Flange Type	Cover
Flange Material and Plating	Brass, Gold

### Environmental Specifications

**Compliance Certifications** (see [product page](#) for current document)

### Plotted and Other Data

Notes:

#### Typical Performance Data

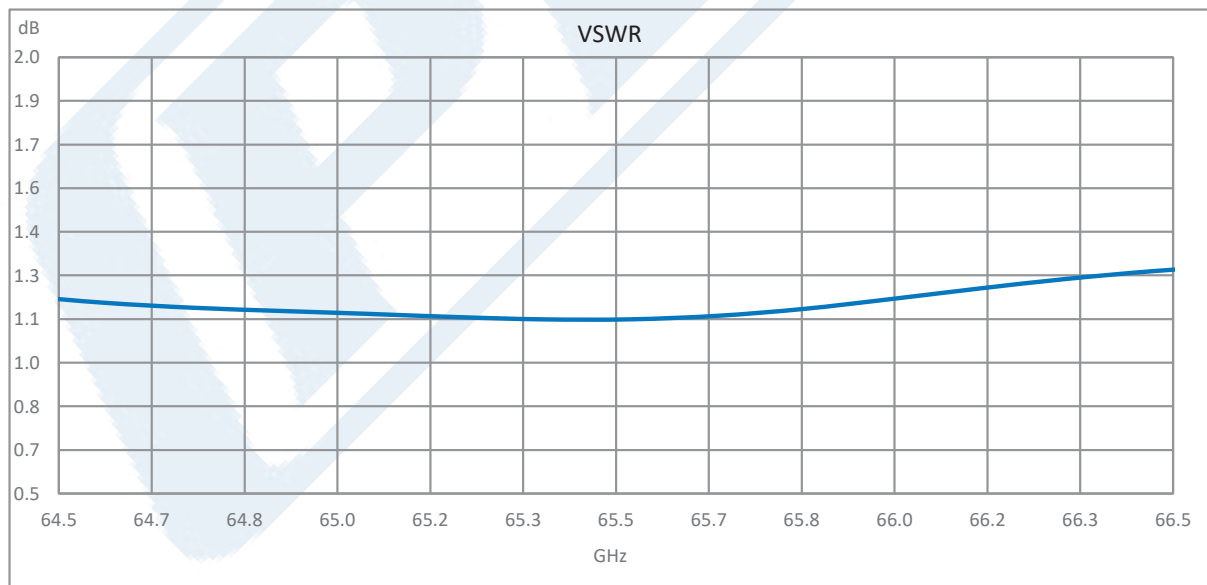

Click the following link (or enter part number in "SEARCH" on website) to obtain additional part information including price, inventory and certifications: [WR-12 Waveguide Circulator, 64.5 GHz to 66.5 GHz, 15 dB min Isolation, UG-387/U Cover Flange, Brass PE-W12CR001](#)



WR-12 Waveguide Circulator, 64.5 GHz to 66.5 GHz,  
15 dB min Isolation, UG-387/U Cover Flange, Brass

## Waveguide Circulators Technical Data Sheet

**PE-W12CR001**

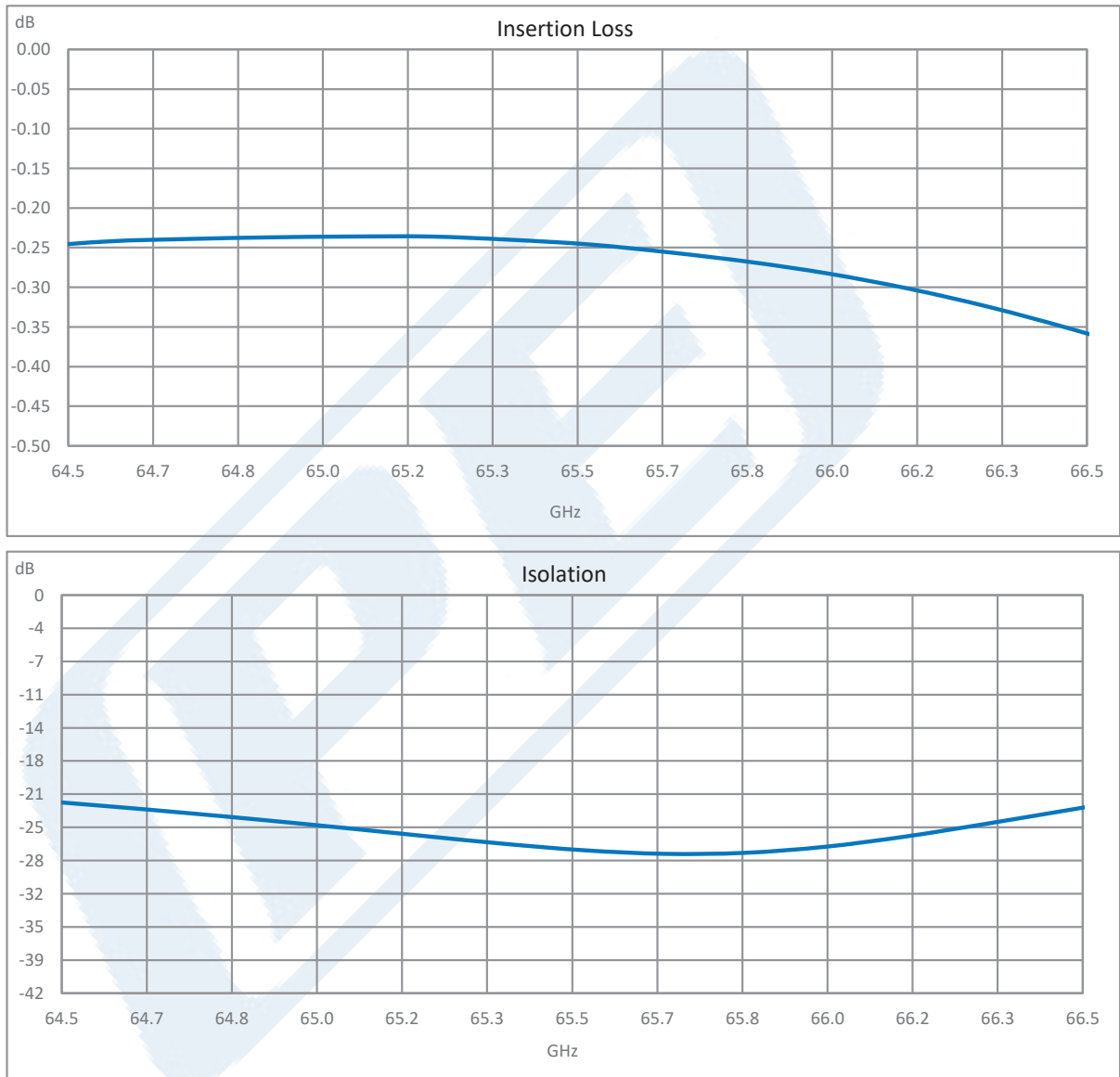

Click the following link (or enter part number in "SEARCH" on website) to obtain additional part information including price, inventory and certifications: [WR-12 Waveguide Circulator, 64.5 GHz to 66.5 GHz, 15 dB min Isolation, UG-387/U Cover Flange, Brass PE-W12CR001](#)



WR-12 Waveguide Circulator, 64.5 GHz to 66.5 GHz,  
15 dB min Isolation, UG-387/U Cover Flange, Brass

## Waveguide Circulators Technical Data Sheet

**PE-W12CR001**

WR-12 Waveguide Circulator, 64.5 GHz to 66.5 GHz, 15 dB min Isolation, UG-387/U Cover Flange, Brass from Pasternack Enterprises has same day shipment for domestic and International orders. Our RF, microwave and millimeter wave products maintain a 99.4% availability and are part of the broadest selection in the industry.

Click the following link (or enter part number in "SEARCH" on website) to obtain additional part information including price, inventory and certifications: [WR-12 Waveguide Circulator, 64.5 GHz to 66.5 GHz, 15 dB min Isolation, UG-387/U Cover Flange, Brass PE-W12CR001](#)

URL:

The information contained in this document is accurate to the best of our knowledge and representative of the part described herein. It may be necessary to make modifications to the part and/or the documentation of the part, in order to implement improvements. Pasternack reserves the right to make such changes as required. Unless otherwise stated, all specifications are nominal. Pasternack does not make any representation or warranty regarding the suitability of the part described herein for any particular purpose, and Pasternack does not assume any liability arising out of the use of any part or documentation.

# PE-W12CR001 CAD Drawing

WR-12 Waveguide Circulator, 64.5 GHz to 66.5 GHz, 15 dB min Isolation, UG-387/U Cover Flange, Brass

F

E

D

C

B

A

F

E

D

C

B

A

1

2

3

4

5

6

7

REVISION			DATE	CHANGED BY	APPROVED
ZONE	REV	DESCRIPTION			
	A	INITIAL RELEASE	02/27/2023	DMAY	SPONG

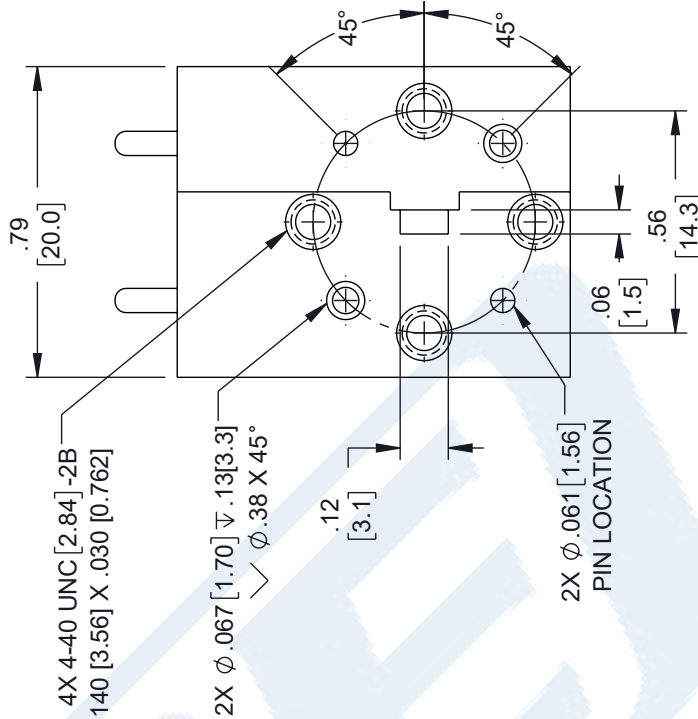
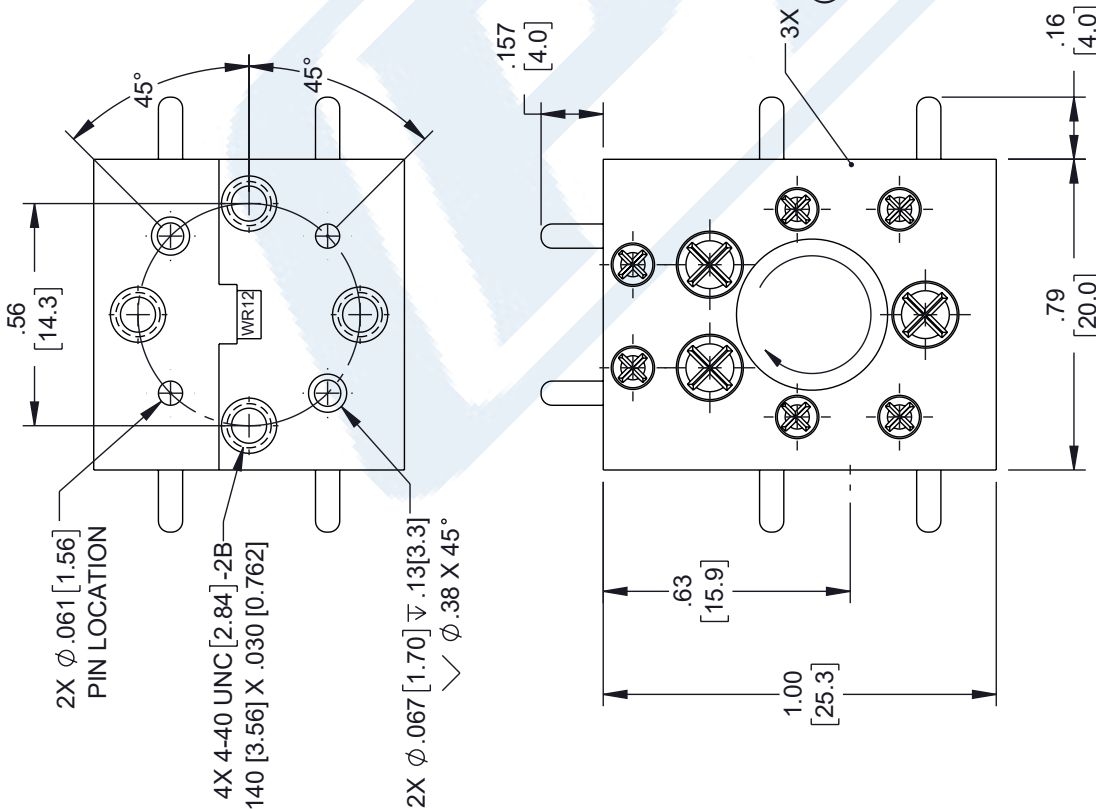

UNLESS OTHERWISE SPECIFIED  
LEADING DIMENSIONS ARE INCHES  
DIMENSIONS IN [ ] ARE MILLIMETERS

TOLERANCES:  
X = ±.2 [5] FRACTIONS  
.XX = ±.02 [.5] ±.132  
.XXX = ±.005 [.13] ANGLES ± 1°

CABLE LENGTH TOLERANCES:  
≤ 12 [305] = +1 [25] / -0  
> 12 [305] ≤ 60 [1524] = +2 [51] / -0  
> 60 [1524] ≤ 120 [3048] = +4 [102] / -0  
> 120 [3048] ≤ 300 [7620] = +6 [152] / -0  
> 300 [7620] = +5% / -0

ALL DIMENSIONS ARE FOR REFERENCE ONLY  
AND SUBJECT TO CHANGE WITHOUT NOTICE

**PE PASTERNAK**  
an INFINITI® brand

Website: [www.Pasternack.com](http://www.Pasternack.com)  
Phone: 1.866.727.8376 | 1.949.261.1920

DESCRIPTION  
WR-12 WAVEGUIDE CIRCULATOR, 64.5-66.5GHz

INTERPRET ALL DIMENSIONS AND  
TOLERANCES PER ASME Y14.5

SCALE

NONE

SHEET

1 OF 1

REV

A

SIZE CASE CODE DRAWN BY ITEM NO.

A 53919 DMAY PE-W12CR001

THE INFORMATION CONTAINED IN THIS DRAWING IS THE SOLE PROPERTY OF INFINITE ELECTRONICS, INC. ANY REPRODUCTION IN  
PART OR WHOLE WITHOUT THE WRITTEN PERMISSION OF INFINITE ELECTRONICS, INC. IS PROHIBITED.  
THESE COMMODITIES, TECHNOLOGY OR SOFTWARE WERE EXPORTED FROM THE UNITED STATES IN ACCORDANCE WITH THE  
EXPORT ADMINISTRATION REGULATIONS. DIVERSION CONTRARY TO U.S. LAW PROHIBITED.