



SMA Female Bulkhead to Reverse Polarity SMA Male Cable 100 cm Length Using RG141 Coax

RF Cable Assemblies Technical Data Sheet

PE3W02965-100CM

Configuration

- Connector 1: SMA Female Bulkhead
- Connector 2: SMA Male Reverse Polarity
- Cable Type: RG141

Features

- Max Frequency 6 GHz
- PTFE (FG) Jacket

Applications

- General Purpose
- Laboratory Use

Description

Pasternack's PE3W02965-100CM SMA female bulkhead to reverse polarity SMA male 100 cm cable using RG141 coax is part of our full line of RF components available for same-day shipping. Pasternack's flexible RF cable assemblies are ideal for applications where tight bends and flexure are required. This Pasternack SMA to reverse polarity SMA cable assembly has a female to male gender configuration with 50 ohm flexible RG141 coax. The PE3W02965-100CM SMA female to reverse polarity SMA male cable assembly operates to 6 GHz. Our RF cable assembly with SMA bulkhead interface allows designers to create external connections on their product enclosures, and can be used in a variety of other rack mount and panel mount applications.

Custom versions of most RF cable assemblies can be built and shipped same day. Custom cable assembly lengths can be obtained by specifying the desired length on the web site at time of order or by contacting a sales representative. Other available RF cable assembly value added services include connector orientation or clocking, heat shrink booting and custom labeling. RF testing can also be performed to document the electrical performance of your cable assembly.

Electrical Specifications

Description	Minimum	Typical	Maximum	Units
Frequency Range	DC		6	GHz
VSWR			1.5:1	
Capacitance		29.4 [96.46]		pF/ft [pF/m]
Jacket Spark			2,000	Vrms

Click the following link (or enter part number in "SEARCH" on website) to obtain additional part information including price, inventory and certifications: [SMA Female Bulkhead to Reverse Polarity SMA Male Cable 100 cm Length Using RG141 Coax PE3W02965-100CM](#)



SMA Female Bulkhead to Reverse Polarity SMA Male Cable 100 cm Length Using RG141 Coax

RF Cable Assemblies Technical Data Sheet

PE3W02965-100CM

Specifications by Frequency

Description	F1	F2	F3	F4	F5	Units
Frequency	0.5	1	2	4	6	GHz
Insertion Loss (Max.)	0.459	0.626	0.813	1.19	1.551	dB

Electrical Specification Notes:

The Insertion Loss data above is based on the performance specifications of the coax use in this assembly. The Insertion Loss includes an estimated insertion loss of 0.2dB of connector Loss

Mechanical Specifications

Cable Assembly

Length* 39.37 in [100 cm]

Cable

Cable Type RG141
Impedance 50 Ohms
Inner Conductor Type Solid
Inner Conductor Material and Plating Copper Clad Steel, Silver
Dielectric Type PTFE
Number of Shields 1
Shield Layer 1 Silver Plated Copper
Jacket Material PTFE (FG), Beige
Jacket Diameter 0.19 in [4.83 mm]

Connectors

Description	Connector 1	Connector 2
Type	SMA Female Bulkhead	SMA Male Reverse Polarity
Impedance	50 Ohms	50 Ohms
Body Material and Plating	Brass, Nickel	Brass, Nickel

Mechanical Specification Notes:

*All cable assemblies have a length tolerance of 1.5% or $\pm 3/8"$, whichever is greater.

Compliance Certifications (see [product page](#) for current document)

Plotted and Other Data

Notes:

Click the following link (or enter part number in "SEARCH" on website) to obtain additional part information including price, inventory and certifications: [SMA Female Bulkhead to Reverse Polarity SMA Male Cable 100 cm Length Using RG141 Coax PE3W02965-100CM](#)



SMA Female Bulkhead to Reverse Polarity SMA
Male Cable 100 cm Length Using RG141 Coax

RF Cable Assemblies Technical Data Sheet

PE3W02965-100CM

How to Order

Part Number Configuration:

PE3W02965

- **xx**

uu

Unit of Measure:
cm = Centimeters
<blank> = Inches
Length
Base Number

Example: PE3W02965-12 = 12 inches long cable
PE3W02965-100cm = 100 cm long cable

SMA Female Bulkhead to Reverse Polarity SMA Male Cable 100 cm Length Using RG141 Coax from Pasternack Enterprises has same day shipment for domestic and International orders. Our RF, microwave and millimeter wave products maintain a 99.4% availability and are part of the broadest selection in the industry.

Click the following link (or enter part number in "SEARCH" on website) to obtain additional part information including price, inventory and certifications: [SMA Female Bulkhead to Reverse Polarity SMA Male Cable 100 cm Length Using RG141 Coax PE3W02965-100CM](https://www.pasternack.com/sma-female-sma-male-rg141au-cable-assembly-pe3w02965-100cm-p.aspx)

URL: <https://www.pasternack.com/sma-female-sma-male-rg141au-cable-assembly-pe3w02965-100cm-p.aspx>

The information contained in this document is accurate to the best of our knowledge and representative of the part described herein. It may be necessary to make modifications to the part and/or the documentation of the part, in order to implement improvements. Pasternack reserves the right to make such changes as required. Unless otherwise stated, all specifications are nominal. Pasternack does not make any representation or warranty regarding the suitability of the part described herein for any particular purpose, and Pasternack does not assume any liability arising out of the use of any part or documentation.

PE3W02965-100CM CAD Drawing **SMA Female Bulkhead to Reverse Polarity SMA Male** **Cable 100 cm Length Using RG141 Coax**

REVISIONS			
REV.	DESCRIPTION	DATE	APPROVED
A	INITIAL RELEASE	04/23/19	SELLIS

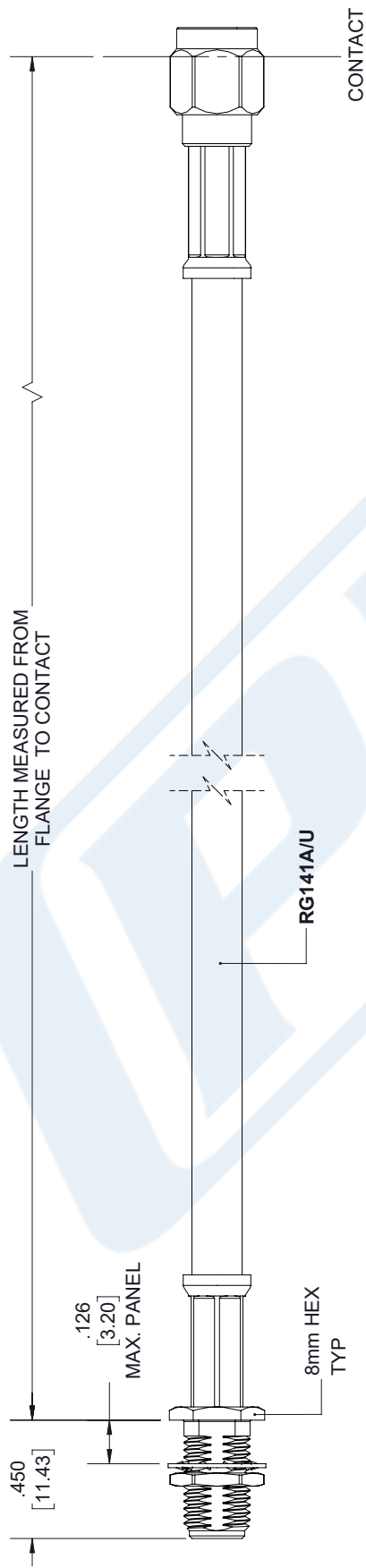

**SMA FEMALE
BULKHEAD**

**RP SMA
MALE**

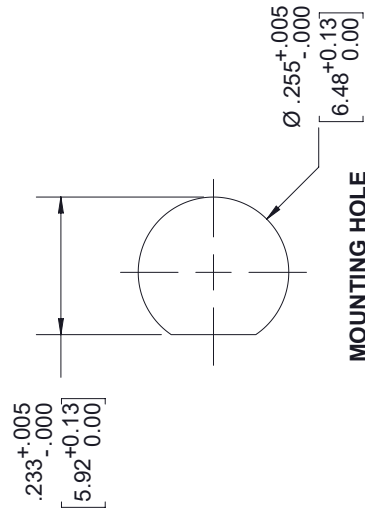

MOUNTING HOLE

UNLESS OTHERWISE SPECIFIED LEADING DIMENSIONS ARE INCHES DIMENSIONS IN [] ARE MILLIMETERS	
TOLERANCES:	FRACTIONS
X±.2 [5.08]	±.132
.XX±.01 [.25]	±.132
.XXX±.005 [.13]	ANGLES ± 1°
ALL DIMENSIONS SHOWN ARE FOR REFERENCE ONLY.	
THIRD-ANGLE PROJECTION	

PE PASTERNAK an INFINITE brand	
Pasternack Enterprises, Inc. P.O. Box 16759, Irvine, CA 92623. Phone: 1.949.261.1920 1.866.727.8376 Fax: 1.949.261.7451 www.pasternack.com e-mail: sales@pasternack.com	
SIZE	PART NUMBER
A	PE3W02965
CAGE	DRAWN BY
53919	K.DANG
REV	
A	

THE INFORMATION AND DESIGN IN THIS DOCUMENT IS THE PROPERTY OF PASTERNAK CORPORATION. ALL RIGHTS RESERVED.	
SHEET	OF
1	1
SCALE	
N/A	

THESE COMMODITIES, TECHNOLOGY OR SOFTWARE WERE EXPORTED FROM THE UNITED STATES IN ACCORDANCE WITH THE EXPORT ADMINISTRATION REGULATIONS. DIVERSION CONTRARY TO U.S. LAW PROHIBITED.