



SMA Female Right Angle Connector Solder Attachment  
2 Hole Flange Mount Pin Terminal, .481 inch Hole  
Spacing, 90 Degree Flange Direction

RF Connectors Technical Data Sheet

PE44237

### Configuration

- SMA Female Connector
- MIL-STD-348
- 50 Ohms
- Right Angle Body Geometry
- Pin Interface Type
- Solder Attachment
- 2 Hole Flange

### Features

- Max. Operating Frequency 18 GHz
- Good VSWR of 1.3:1
- Gold Plated Beryllium Copper Contact
- Contact plating according to MIL-G-45204

### Applications

- General Purpose Test
- Rack and Panel Mount Applications

### Description

Pasternack's PE44237 SMA female right angle 2 hole flange mount connector with solder attachment pin terminal (.481 inch hole spacing) is part of our full line of RF components available for same-day shipping. Our SMA female connector operates up to a maximum frequency of 18 GHz and offers good VSWR of 1.3:1. Its right angle body geometry allows for easier connections in tight spaces. This SMA 2 hole flange connector allows designers to create external connections on their product enclosures, and can be used in a variety of other rack mount and panel mount applications.

Our SMA female right angle 2 hole flange connector PE44237 datasheet specifications and drawing with dimensions are shown below in this PDF. Pasternack's broad catalog of RF, microwave and millimeter wave connectors allows designers to configure and customize their signal connections however they like. Whether the need is to provide an I/O for a board design, or simply create a custom cable assembly configuration, Pasternack has the right connector for the job. Pasternack can also expertly build your custom cable assemblies for you and ship same-day.

### Electrical Specifications

Description	Minimum	Typical	Maximum	Units
Frequency Range	DC		18	GHz
VSWR			1.3:1	
Operating Voltage (AC)			500	Vrms
Dielectric Withstanding Voltage (AC)			1,500	Vrms
Insulation Resistance	5,000			MOhms

### Mechanical Specifications

#### Size

Length	1.205 in [30.61 mm]
Width/Dia.	0.625 in [15.88 mm]
Height	0.598 in [15.19 mm]

Click the following link (or enter part number in "SEARCH" on website) to obtain additional part information including price, inventory and certifications: [SMA Female Right Angle Connector Solder Attachment 2 Hole Flange Mount Pin Terminal, .481 inch Hole Spacing, 90 Degree Flange Direction PE44237](#)



SMA Female Right Angle Connector Solder Attachment  
2 Hole Flange Mount Pin Terminal, .481 inch Hole  
Spacing, 90 Degree Flange Direction

RF Connectors Technical Data Sheet

PE44237

Weight 0.014 lbs [6.35 g]

**Material Specifications**

Description	Material	Plating
Contact	Beryllium Copper	Gold MIL-G-45204
Insulation	PTFE	
Body	Brass	Gold MIL-G-45204

**Environmental Specifications**

**Temperature**

Operating Range -65 to +165 deg C

**Compliance Certifications** (see [product page](#) for current document)

**Plotted and Other Data**

Notes:

SMA Female Right Angle Connector Solder Attachment 2 Hole Flange Mount Pin Terminal, .481 inch Hole Spacing, 90 Degree Flange Direction from Pasternack Enterprises has same day shipment for domestic and International orders. Our RF, microwave and millimeter wave products maintain a 99% availability and are part of the broadest selection in the industry.

Click the following link (or enter part number in "SEARCH" on website) to obtain additional part information including price, inventory and certifications: [SMA Female Right Angle Connector Solder Attachment 2 Hole Flange Mount Pin Terminal, .481 inch Hole Spacing, 90 Degree Flange Direction PE44237](#)

URL: <https://www.pasternack.com/sma-female-standard-pin-terminal-connector-pe44237-p.aspx>

The information contained in this document is accurate to the best of our knowledge and representative of the part described herein. It may be necessary to make modifications to the part and/or the documentation of the part, in order to implement improvements. Pasternack reserves the right to make such changes as required. Unless otherwise stated, all specifications are nominal. Pasternack does not make any representation or warranty regarding the suitability of the part described herein for any particular purpose, and Pasternack does not assume any liability arising out of the use of any part or documentation.

PE44237 CAD Drawing

SMA Female Right Angle Connector Solder Attachment 2 Hole Flange Mount  
Pin Terminal, .481 inch Hole Spacing, 90 Degree Flange Direction

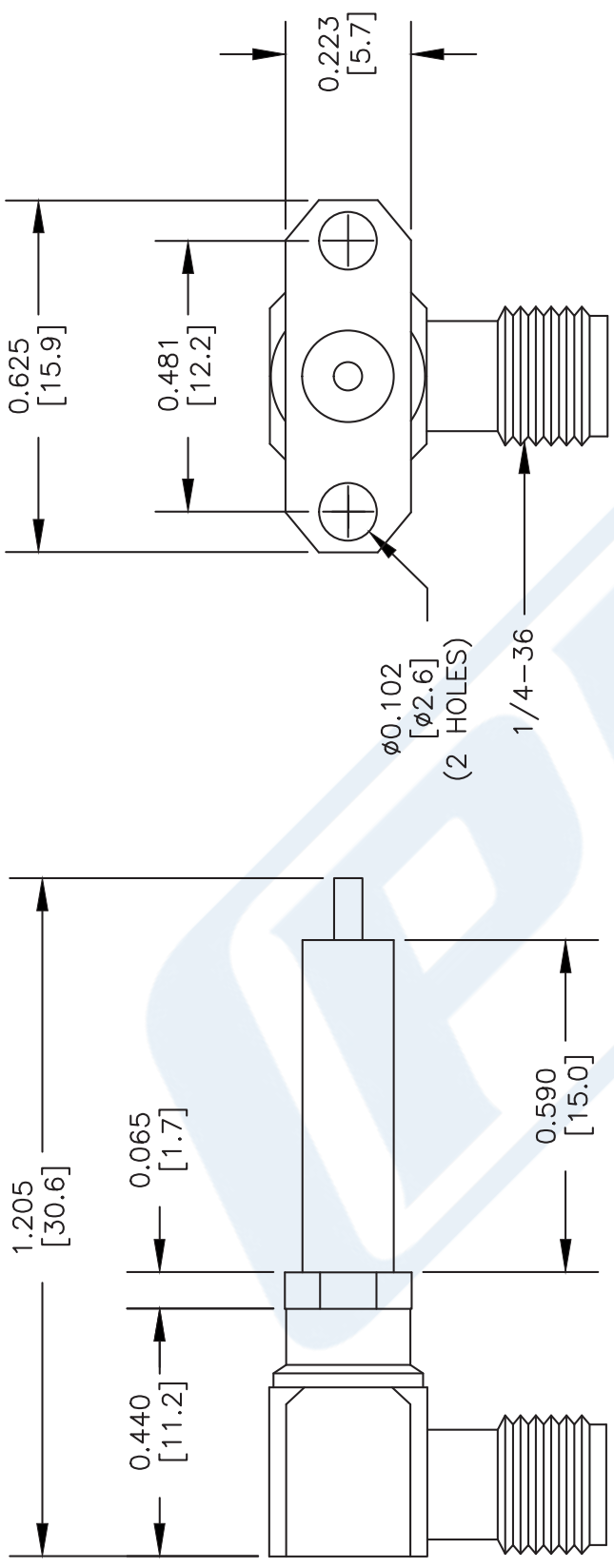

NOTES:  
1. UNLESS OTHERWISE SPECIFIED ALL DIMENSIONS ARE NOMINAL.  
2. ALL SPECIFICATIONS ARE SUBJECT TO CHANGE WITHOUT NOTICE AT ANY TIME.  
3. DIMENSIONS ARE IN INCHES [mm].  
4. FITS MIL-C-17 AND EQUIVALENT CABLES.

DWG TITLE  
**PE44237**

FSCM NO. 53919

CAD FILE 070202  
SCALE N/A  
SIZE A  
XXXX

**PE PASTERNAK®**  
Pasternack Enterprises, Inc.  
P.O. Box 16759 | Irvine | CA | 92623  
Phone: (949) 261-1920 | Fax: (949) 261-7451  
Website: [www.pasternack.com](http://www.pasternack.com) | E-Mail: [sales@pasternack.com](mailto:sales@pasternack.com)