



Reverse Polarity SMA Female Bulkhead Mount Connector Crimp/  
Solder Attachment for RG188-DS, RG316-DS, .235 inch D Hole

TECHNICAL DATA SHEET

PE45189

**Configuration**

|                                    |                             |
|------------------------------------|-----------------------------|
| Connector                          | SMA Female Reverse Polarity |
| Connector Interface Type           | RG188-DS, RG316-DS          |
| Attachment Method (Shield/Contact) | Crimp/Solder                |
| Body Style                         | Straight                    |
| Mount Method                       | Bulkhead                    |

**Electrical Specifications**

|           |         |
|-----------|---------|
| Impedance | 50 Ohms |
|-----------|---------|

**Mechanical Specifications**

**Size**

|            |                    |
|------------|--------------------|
| Length     | 1.08 in [27.43 mm] |
| Width/Dia. | 0.312 in [7.92 mm] |
| Weight     | 0.006 lbs [2.72 g] |

**Connector**

|                              |                             |
|------------------------------|-----------------------------|
| Type                         | SMA Female Reverse Polarity |
| Contact Material and Plating | Gold                        |
| Body Material and Plating    | Brass, Nickel               |
| Dielectric Type              | PTFE                        |

**Compliance Certifications** (visit [www.Pasternack.com](http://www.Pasternack.com) for current document)

|                 |            |
|-----------------|------------|
| RoHS Compliant  |            |
| REACH Compliant | 06/18/2012 |

Click the following link (or enter part number in "SEARCH" on website) to obtain additional part information including price, inventory and certifications: [Reverse Polarity SMA Female Bulkhead Mount Connector Crimp/Solder Attachment for RG188-DS, RG316-DS, .235 inch D Hole PE45189](#)



## Reverse Polarity SMA Female Bulkhead Mount Connector Crimp/ Solder Attachment for RG188-DS, RG316-DS, .235 inch D Hole

### TECHNICAL DATA SHEET

PE45189

#### Plotted and Other Data

Notes:

- Values at +25 °C, sea level

Reverse Polarity SMA Female Bulkhead Mount Connector Crimp/Solder Attachment for RG188-DS, RG316-DS, .235 inch D Hole from Pasternack Enterprises has same day shipment for domestic and International orders. Our RF, microwave and millimeter wave products maintain a 99% availability and are part of the broadest selection in the industry.

Click the following link (or enter part number in "SEARCH" on website) to obtain additional part information including price, inventory and certifications: [Reverse Polarity SMA Female Bulkhead Mount Connector Crimp/Solder Attachment for RG188-DS, RG316-DS, .235 inch D Hole PE45189](http://www.pasternack.com/sma-female-reverse-polarity-rg188-ds-rg316-ds-connector-pe45189-p.aspx)

URL: <http://www.pasternack.com/sma-female-reverse-polarity-rg188-ds-rg316-ds-connector-pe45189-p.aspx>

The information contained in this document is accurate to the best of our knowledge and representative of the part described herein. It may be necessary to make modifications to the part and/or the documentation of the part, in order to implement improvements. Pasternack reserves the right to make such changes as required. Unless otherwise stated, all specifications are nominal. Pasternack does not make any representation or warranty regarding the suitability of the part described herein for any particular purpose, and Pasternack does not assume any liability arising out of the use of any part or documentation.

# PE45189 CAD Drawing

Reverse Polarity SMA Female Bulkhead Mount Connector Crimp/  
Solder Attachment for RG188-DS, RG316-DS, .235 inch D Hole

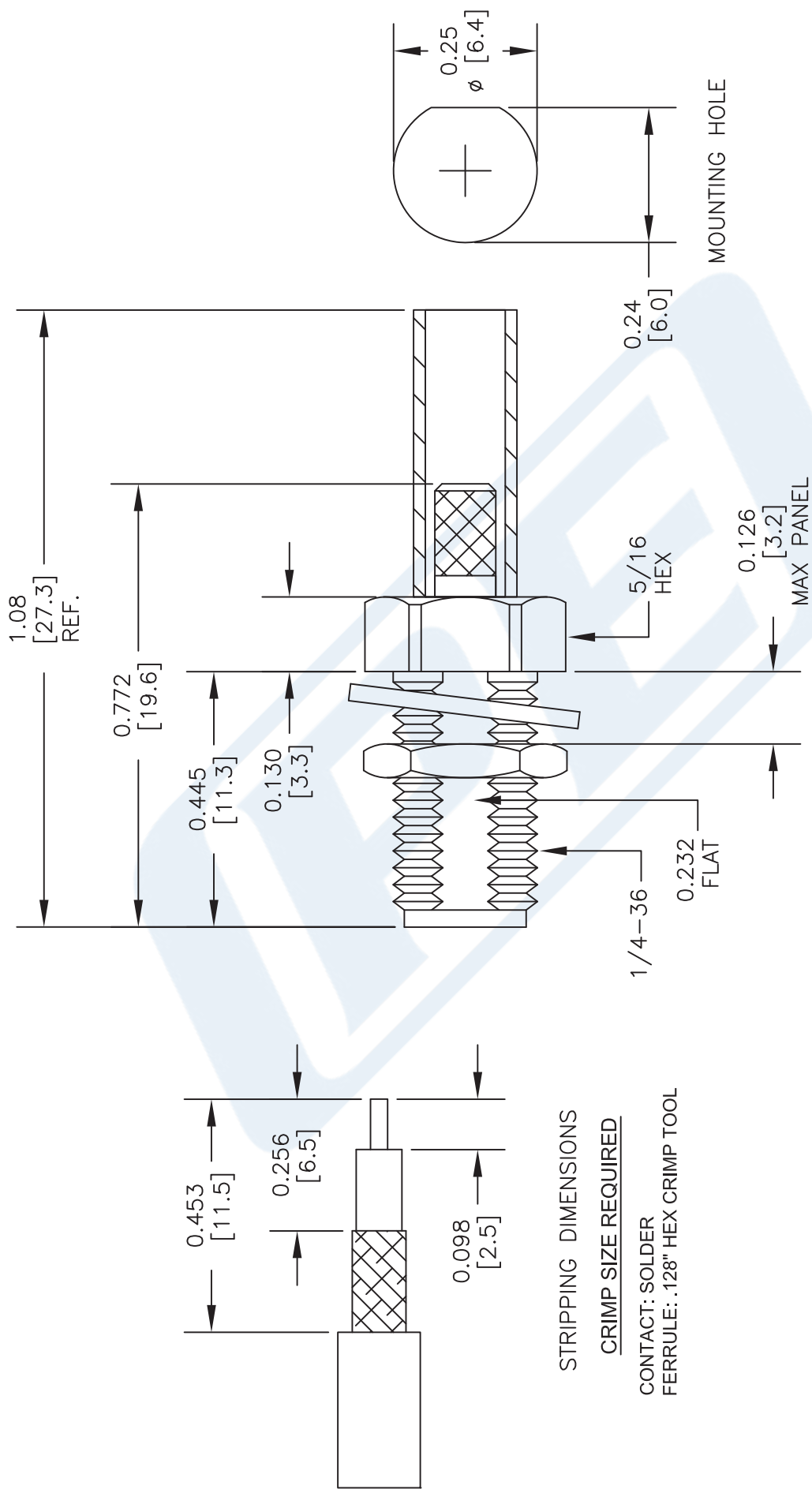

DWG TITLE

PE45189

- NOTES:
1. UNLESS OTHERWISE SPECIFIED ALL DIMENSIONS ARE NOMINAL.
  2. ALL SPECIFICATIONS ARE SUBJECT TO CHANGE WITHOUT NOTICE AT ANY TIME.
  3. DIMENSIONS ARE IN INCHES [mm].
  4. FITS MIL-C-17 AND EQUIVALENT CABLES.

**PE PASTERNAK®**  
THE ENGINEER'S RF SOURCE  
Pasternack Enterprises, Inc.  
P.O. Box 16759 | Irvine | CA | 92623  
Phone: (949) 261-1920 | Fax: (949) 261-7451  
Website: www.pasternack.com | E-Mail: sales@pasternack.com

FSCM NO. 53919

CAD FILE 031715

SCALE N/A

SIZE A

2233