



## 25 Watt RF Load Up To 8 GHz With 7/16 DIN Female Input Round Body Black Anodized Aluminum Heatsink

### RF Terminations Technical Data Sheet

PE6210

#### Electrical Specifications

Description	Minimum	Typical	Maximum	Units
Frequency Range	DC		8	GHz
Impedance		50		Ohms
VSWR			1.6:1	
Input Power (CW)			25	Watts
Input Power (Peak)			500	Watts

#### Mechanical Specifications

##### Size

Length	3.9 in [99.06 mm]
Width	2.3 in [58.42 mm]
Weight	2.5 lbs [1.13 kg]
Finish	Black

##### Configuration

Connector	7/16 DIN Female
Connector Specification	MIL-STD-348

#### Material Specifications

Description	Material	Plating
Connector 1 Contact	Brass	Silver
Insulation	PTFE	
Outer Conductor	Brass	Silver
Body	Brass	Silver
Housing	Black Anodized Aluminum Heatsink	

#### Environmental Specifications

##### Temperature

Operating Range	-65 to +125 deg C
-----------------	-------------------

Click the following link (or enter part number in "SEARCH" on website) to obtain additional part information including price, inventory and certifications: [25 Watt RF Load Up To 8 GHz With 7/16 DIN Female Input Round Body Black Anodized Aluminum Heatsink PE6210](#)



## 25 Watt RF Load Up To 8 GHz With 7/16 DIN Female Input Round Body Black Anodized Aluminum Heatsink

### RF Terminations Technical Data Sheet

PE6210

**Compliance Certifications** (see [product page](#) for current document)

#### Plotted and Other Data

Notes:

25 Watt RF Load Up To 8 GHz With 7/16 DIN Female Input Round Body Black Anodized Aluminum Heatsink from Pasternack Enterprises has same day shipment for domestic and International orders. Our RF, microwave and millimeter wave products maintain a 99.4% availability and are part of the broadest selection in the industry.

Click the following link (or enter part number in "SEARCH" on website) to obtain additional part information including price, inventory and certifications: [25 Watt RF Load Up To 8 GHz With 7/16 DIN Female Input Round Body Black Anodized Aluminum Heatsink PE6210](#)

URL: <https://www.pasternack.com/25-watts-7-16-female-rf-load-up-to-8-ghz-pe6210-p.aspx>

The information contained in this document is accurate to the best of our knowledge and representative of the part described herein. It may be necessary to make modifications to the part and/or the documentation of the part, in order to implement improvements. Pasternack reserves the right to make such changes as required. Unless otherwise stated, all specifications are nominal. Pasternack does not make any representation or warranty regarding the suitability of the part described herein for any particular purpose, and Pasternack does not assume any liability arising out of the use of any part or documentation.

# PE6210 CAD Drawing

25 Watt RF Load Up To 8 GHz With 7/16 DIN Female Input  
Round Body Black Anodized Aluminum Heatsink

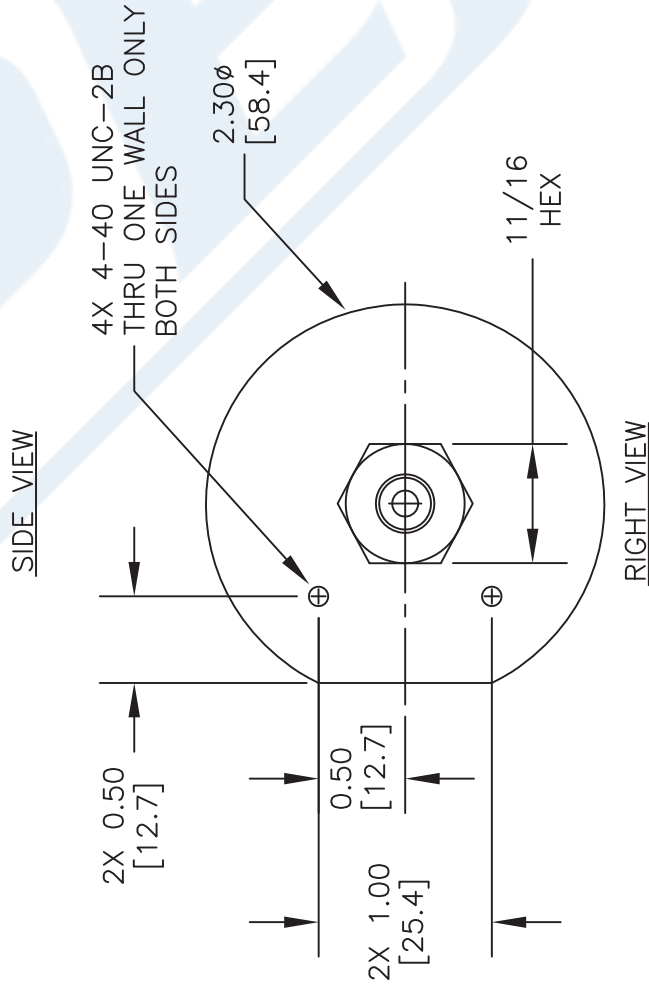
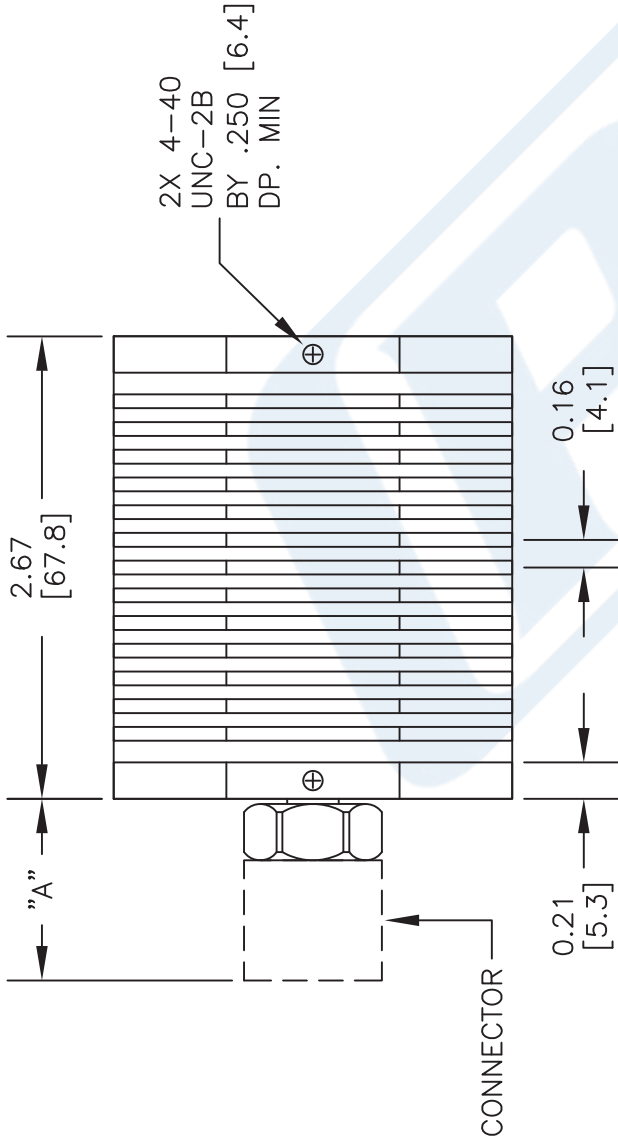

Table of Information		Part Number Configuration	
Connector Type	DIM "A" (REF.)	PN	Connector
SMA Male	0.68	PE6203	SMA Male
SMA Female	0.54	PE6204	SMA Female
N Male	0.98	PE6205	N Male
N Female	0.95	PE6206	N Female
TNC Male	0.98	PE6207	TNC Male
TNC Female	0.94	PE6208	TNC Female
7/16 Male	1.12	PE6209	7/16 Male
7/16 Female	1.16	PE6210	7/16 Female

DWG TITLE

**PE62xx**

NOTES:  
1. UNLESS OTHERWISE SPECIFIED ALL DIMENSIONS ARE NOMINAL.  
2. ALL SPECIFICATIONS ARE SUBJECT TO CHANGE WITHOUT NOTICE AT ANY TIME.  
3. DIMENSIONS ARE IN INCHES [mm].

**Pasternack Enterprises, Inc.**  
P.O. Box 16759 | Irvine | CA | 92623  
Phone: (949) 261-1920 | Fax: (949) 261-7451  
Website: www.pasternack.com | E-Mail: sales@pasternack.com

FSCM NO. 53919

CAD FILE 080213

SCALE N/A

SIZE A

2233